

**BEFORE SALIVA COLLECTION: Please DO NOT eat, drink, smoke, or chew gum 30 minutes prior to collection.**

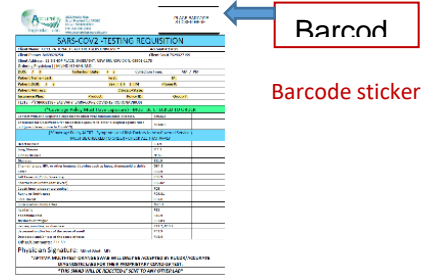

Barcode sticker

1. Print your Requisition Form from: <https://rtr.ipo.rutgers.edu/covid/questionnaire/>  
Take **barcode sticker** and place it on the **top right corner of** Requisition Form (Lab slip).  
**\*\*\*SAMPLE MUST INCLUDE PRINTED REQUISITION FORM \*\*\***

2. Clearly hand print in ink your name and date of birth on the **blank sticker** provided (or use the pretyped name sticker if provided in your bag) and then place it **lengthwise on collection tube**. DO NOT cover the existing bar code on the tube.

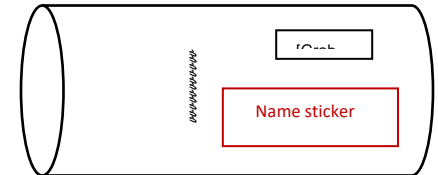

**Then, perform saliva collection as follows**

STEP 1



**FILL THE TUBE WITH SALIVA TO THE BLACK WAVY LINE.**

Fill the tube until your saliva (not including bubbles) is at or just above the wavy line. **DO NOT OVERFILL.** Let saliva pool in mouth before spitting to avoid bubbles. Gently tap tube to remove any bubbles.

STEP 2

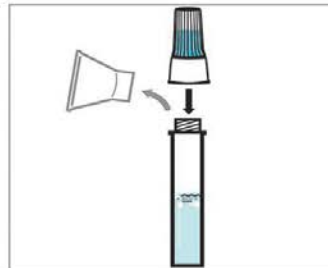

**REPLACE THE FUNNEL WITH THE FLUID CAP.**

Remove the funnel from the tube. Screw on the enclosed cap **TIGHTLY** to release the solution that will stabilize the DNA in your saliva.

STEP 3

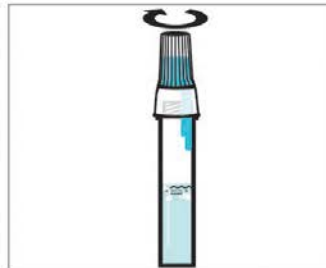

**SCREW CAP DOWN TO RELEASE SOLUTION.**

You will know it works when the blue solution from the cap is released into the tube.

STEP 4

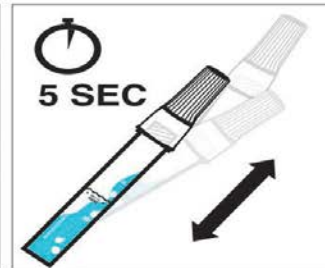

**SPECTRUMDNA**

**SHAKE THE TUBE FOR AT LEAST FIVE SECONDS.**

This will ensure your sample mixes thoroughly with the stabilizing solution.

**\*\*\* After completion, place capped tube in collection bag along with testing requisition form and seal bag. \*\*\***